

BLUESEAL

The BlueSeal is one design suited for future engine dynamic sealing.

This patented radial shaft seal technology offers weight savings of 25 percent compared to a conventional seal, and it requires only half as much installation space.

A specific design has been developed to be mechanically resistant to high pressures, while the PTFE material of the seal lip stands up to aggressive substances.

VALUES TO THE CUSTOMER

The BlueSeal technology has been developed specifically to achieve the following advantages:

- PTFE chemical inertia
- Low friction POP® lip design
- Axial space reduction which allows to downsize the engine or which can be used for an additional function
- Weight reduction

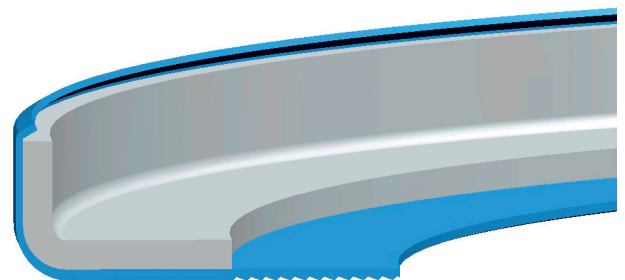
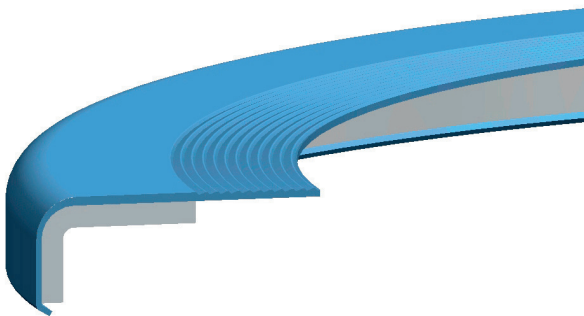

BLUESEAL



FEATURES AND BENEFITS

Characteristic	Effect	Result for customer
PTFE as single material	<ul style="list-style-type: none"> Use of all PTFE advantages 	<ul style="list-style-type: none"> Full compatibility with oils and fuels Fits with a global use in different regions of the world
Low friction (PTFE POP® lip design)	<ul style="list-style-type: none"> Small dissipation loss Temperature reduction in the contact area Good performance in engine conditions 	<ul style="list-style-type: none"> Mass production with PTFE POP lip Higher efficiency Reduction of shaft wear Reduction of oil carbonization
Downsized design	<ul style="list-style-type: none"> Minimum height required for a BlueSeal -50% compared to traditional seals 	<ul style="list-style-type: none"> More compact than solutions available on the market
Weight reduction	<ul style="list-style-type: none"> Reduction down to -40% compared to traditional seals 	<ul style="list-style-type: none"> Contribution to CO₂ emission reduction
Pumping effect	<ul style="list-style-type: none"> Seal lubrication Perfect sealing behavior 	<ul style="list-style-type: none"> Increased sealing system durability
Specific design	<ul style="list-style-type: none"> Higher resistance to pressure 	<ul style="list-style-type: none"> Robust design for applications like injection pumps

The information contained herein is believed to be reliable, but no representation, guarantees or warranties of any kind are made to its accuracy or suitability for any purpose. The information presented herein is based on laboratory testing and does not necessarily indicate end product performance. Full scale testing and end product performance are the responsibility of the user.